

# Accommodation in Winterberg



The retreat venue  
for the German Sangha & their friends

3 steps to your accommodation!

## 1

Choose one of the specified accommodation options.

Please let us know who you would like to share a room with.

## 2

Complete the booking form and return it to:

**Rigpa e. V.**  
**Attention of Holger Sieler**

## 3

From **30<sup>th</sup> of September**, billing by the Dorint Hotel and Sports Resort will be carried out.

The invoice needs to be paid **within 7 working days**.

## 1 Choose the appropriate accommodation for you

- All accommodations have cooking facilities: Hotel rooms have small kitchenettes, in the chalets there are kitchens. All are equipped with essential kitchen utensils. For your information: The restaurants offer a small choice of meals, ranging from 5 to 25 EUR, vegetarian, vegan and glutenfree meals are available.
- All double beds can be separated and transformed into single beds.
- All chalets have balcony or terrace.
- All indicated prices pertain 9 nights between 23<sup>th</sup> of October until 1<sup>st</sup> of November.
- Free WiFi on the premises.
- Unfortunately, there is no accessible housing. People with walking disabilities or using a wheelchair are asked to book external accommodation. For advice please contact [holger.sielers@rigpa.de](mailto:holger.sielers@rigpa.de). The shrine room is barrier-free accessible.

### Hotel

#### Margarite standard room · 32 sqm

1 room with kitchenette and double bed

*Additional cot possible*

double **405 EUR per person**

single **702 EUR**

#### Mohn comfort apartment · 52 sqm

1 diningroom with kitchenette

1 bedroom with double bed

*Additional cot possible*

double **495 EUR per person**

single **882 EUR**

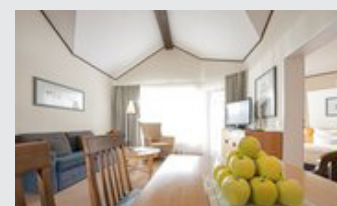

## Chalets

Igel apartment · 2 people · 52 sqm

1 bedroom (1 double room)

1 sitting room with dinette, kitchen

bathroom and wc, separate guest wc

terrace/balcony

*children's sleeping berth possible  
on couch in sitting room!*

chalet 855 EUR

double 427.50 EUR per person



Hase chalet · 4 people · 67 sqm

2 bedroom (2 double room)

1 sitting room with dinette, kitchen

bathroom with wc, separate guest wc

terrace/balcony

*children's sleeping berth possible  
on couch in sitting room!*

chalet 1.188 EUR

double 297 EUR per person



Reh chalet · 5 people · 79 sqm

3 bedroom (2 double and 1 single)

1 sitting room with dinette, kitchen

bathroom with wc, separate guest wc

terrace/balcony

*children's sleeping berth possible  
on couch in sitting room!*

chalet 1.350 EUR

single 450 EUR/ double 225 EUR p. p.\*

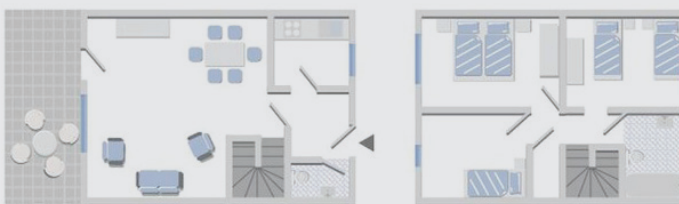

\* per person

- **All given prices are complete prices from 23<sup>th</sup> October, 5 pm to 1<sup>st</sup> November, 10 am.** VAT is included as well as cleaning at the end by Neue Dorint GmbH.
- **Children are very welcome in Winterberg!**
  - Placement of a child** (additional bed, sleeping couch or baby bed)
    - Up to 11 ys. **free of charge**
    - 12 - 16 ys. **190 EUR in the hotel, free of charge in chalet**
  - Catering in the restaurant of Neue Dorint GmbH**
    - 0-5 ys. **free of charge**
    - 6-11 ys. **50% discount**
    - 12-16 ys. **25% discount**
- The chalets/hotel rooms will be occupied to a maximum, according to possibilities, to guarantee as many participants as possible to stay onsite. In case of single occupancy of a double room the full price for a double room must be paid (example: chalet "Hase": for the double room, 594 EUR will be charged for single occupancy).
- The Hotel offers various options for breakfast.

**Additional amenities** (can be booked onsite):

- House cleaning: chalet "Reh": 15 EUR/day, "Hase": 12,50 EUR/day; apartment "Igel": 10 EUR/day
- 120 parking spaces are available in the parking deck. They can be booked for 50 EUR/whole period.

# Booking form

Dorint

Hotel & Sportresort  
Winterberg · Sauerland

**Binding Booking – not to cancel**

Please use one form per invoice recipient

**Time period for (9 overnight stays)**

**23<sup>th</sup> of October to**

**31<sup>th</sup> of October | departure 1<sup>st</sup> of November**

All given price are complete prices for the specified period.

A = adult SR = single room DR = double room

Hotel	Number adults	SR	DR	Number children	Age	Camp bed /Couch	Number of baby bed	Price in EUR
<b>Margarite standard room</b> Double occupancy 405 EUR per person single room 702 EUR								
<b>Mohn comfort apartment</b> Double occupancy 495 EUR per person single room 882 EUR								
<b>Chalet</b>								
<b>Igel apartment · houseprice 855 EUR</b> DR 427.50 EUR per person								
<b>Hase chalet · houseprice 1.188 EUR</b> DR 297 EUR per person								
<b>Reh chalet · houseprice 1.350 EUR</b> DR 225 EUR per person / SR 450 EUR								
<b>Further amenities</b> (can also be booked later outside)							Number days	
<b>House service</b> Reh 15 EUR/day; Hase 12,50 EUR/day, Igel 10 EUR/day								
<b>Parking</b> 50 EUR/23 <sup>th</sup> of October to 1 <sup>st</sup> of November								

**Full price in EUR**

Please indicate here who you would like to share your room or, where applicable, your chalet with:

Name, First Name (Guest 1 = invoice recipient)

Name, First Name (Guest 2)

Name, First Name (Guest 3 - 5)

Name, First Name (children)

E-Mail

Street, Postcode, Town, Country

Fon

Room for further important information (e.g. handicap etc.)

Place, Date

Signature\*

\*By signing I acknowledge the booking as binding and accept the transmittance of my data for billing to the Neue Dorint GmbH.  
Billing will start the 30<sup>th</sup> of September, the invoice needs to be paid within 7 working days.